



EURO VISTA PIVOT™

IMPACT & NON-IMPACT ALUMINUM & WOOD PIVOT DOORS

Approved for use in Miami-Dade HVHZ Zones
Florida Building Code Approved
Product Approval FL 22410

www.euro-wall.com
888.989.EURO (3876)

euro-wall®



FOLDING



SLIDING



STACKING



PIVOT

SYSTEM THRESHOLDS

Maximum / Minimum Specifications

Max Panel Weight:	700 lbs
Min Panel Width:	36"
Max Panel Width:	96"
Min Panel Height:	48"
Max Panel Height:	144"
Panel Thickness:	2-1/4" to 3-1/2"

NOTE: The Euro Pivot™ Door comes in aluminum, aluminum with wood clad, wood and wood with aluminum clad options. The Euro Pivot™ door can also be configured with either an outswing or an inswing. For installations in Florida, please see the Florida Product Approval for usage and limitations.

SYSTEM HIGHLIGHTS

Aluminum Pivot Panel Specifications

Extruded aluminum 6063-T5 with door panel corner keys for strength and security / optional wood clad finish available

Wood Pivot Panel Specifications

From 2-1/4" - 3-1/2" thick / optional aluminum clad finish available in AAMA 2604 and 2605

Hardware

Stainless steel (316/304SS) components with aluminum hinges

Lever Lock Sets

3 hooks + top & bottom shootbolts = 5 point locking system

Multi-point Door Locks

Faceplate, latch and hooks are 304SS

No Sills

No sills necessary

Matching Fixed Units

Matching Florida Product Approved impact rated transom and sidelight units available

Largest Impact Rated Panel Sizes

120" tall / 72" wide panels - the largest available HVHZ impact tested and Florida Product Approved pivot door

Under Pressure

Highest design pressure available for any impact rated pivot door - up to 60+/-

Aesthetics

Muntins, simulated divided lites, mid-rails, custom wood cladding, custom aluminum cladding...the sky's the limit with the Euro Vista Pivot™ customization options

Ladder Pull

Available in sizes ranging from 18" - 72" to meet the needs of your application

Self Closure

Hydraulic self closure option available

Long Lasting Finish

AAMA 2605 coating is the standard finish for all aluminum pivot doors

SYSTEM COMPONENTS / OPERATION

(Aluminum pivot door shown below; configurations are valid for all pivot door types)

TOP VIEW - Horizontal Cross Section

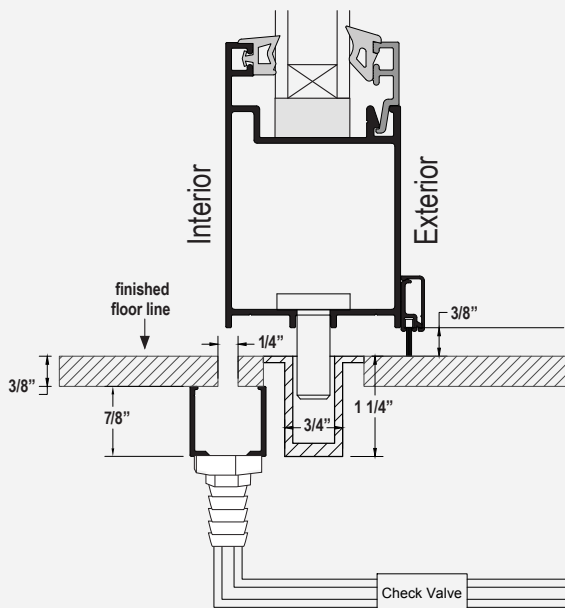
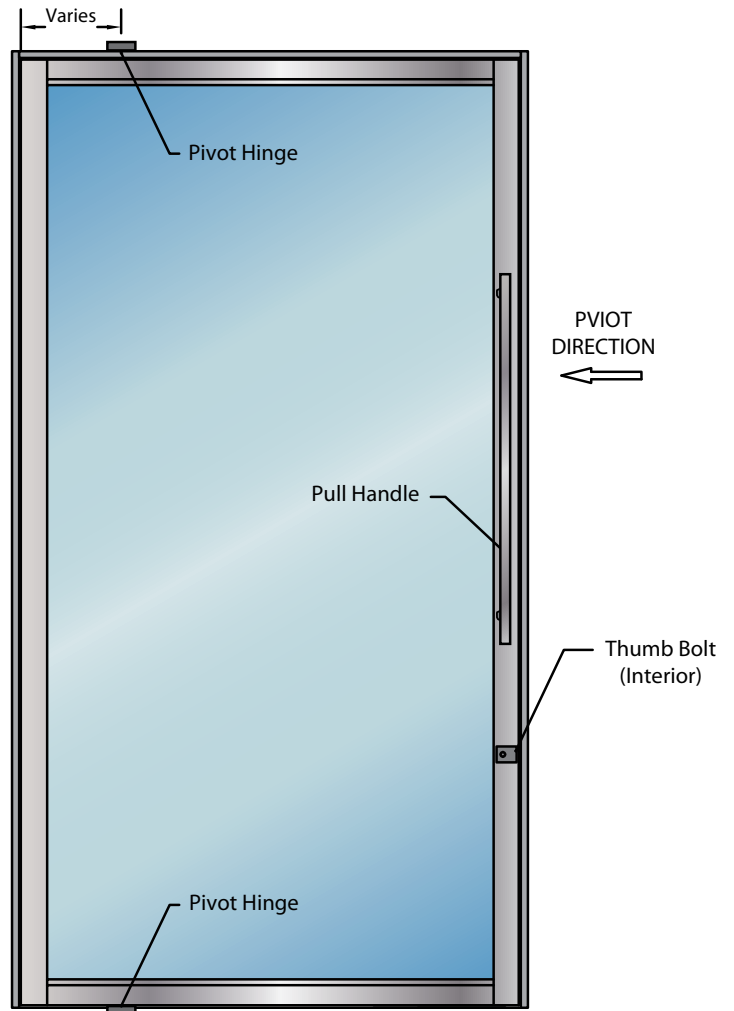
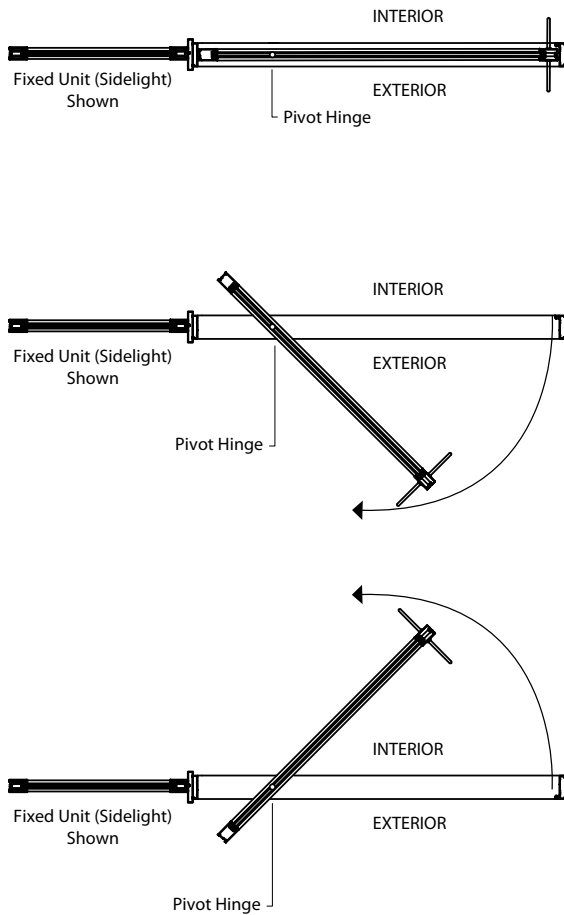

OPTIONAL DRAINAGE SYSTEM

Euro-Wall offers an optional water drainage system that allows water to drain away from the pivot door location.

NOTE: This is a non water rated door in the state of Florida.

ALUMINUM & WOOD PANEL FINISH OPTIONS

STANDARD FRAME & ALUMINUM PANEL FINISHES

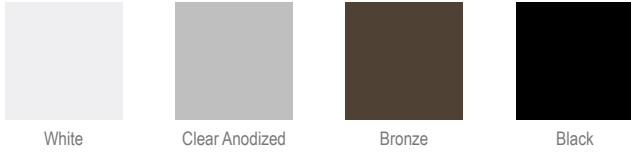

- Anodized, powder coat or Kynar® finishes available
- Custom powder coat or Kynar® finishes available
- Manufacturer color match options
- 40 Custom wood grain finishes available

INTERIOR WOOD CLAD FINISH OPTION

- Douglas Fir
- Mahogany / Sapele
- White Oak



STANDARD WOOD PANEL FINISHES



In addition to the three standard wood finishes, Euro-Wall's Euro Vista Stack™ wood panel can be finished with a wide variety of other exotic species. Please see page 7 of this brochure for additional custom wood options.

ALUMINUM CLAD FINISH OPTION

- White
- Clear Anodized
- Bronze
- Black

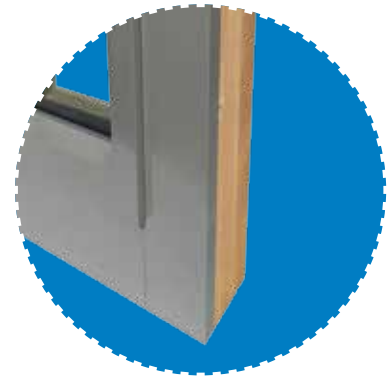

HANDLE OPTIONS

MULTIPOINT LOCK HANDLE



Available Finishes

- Polished Stainless Steel**
- Brushed Satin**
- Bronze**
- Black**

TRACK / FRAME

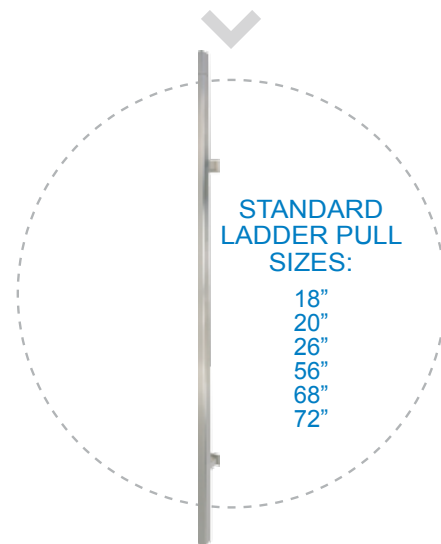

STANDARD LADDER PULL SIZES:

- 18"
- 20"
- 26"
- 56"
- 68"
- 72"

Available Finishes

- Polished Stainless Steel**
- Brushed Satin**
- Bronze**
- Black**

EURO PIVOT™ DOOR PANEL OPTIONS

The illustrations below are just a few examples of the countless possibilities for the aluminum & wood Euro Pivot™ door.

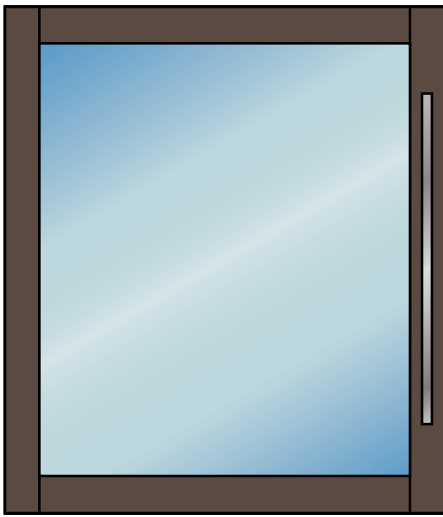

1

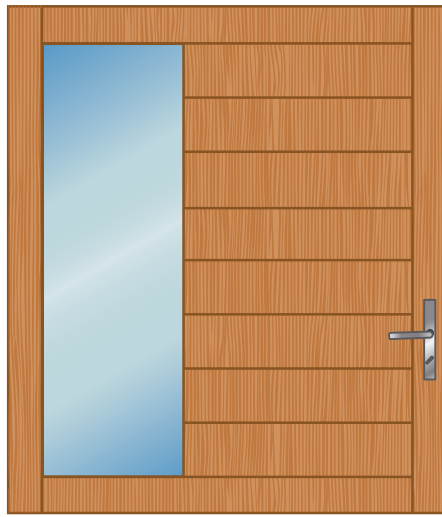

*2

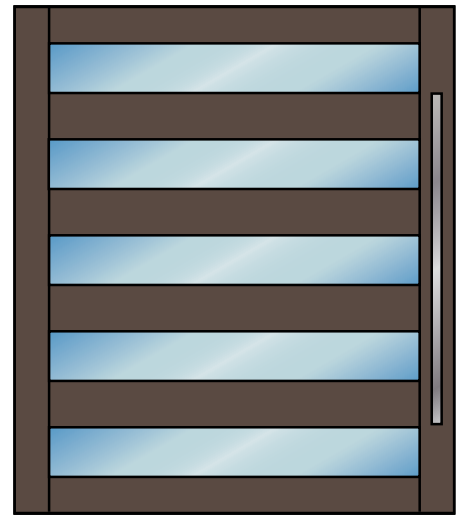

3

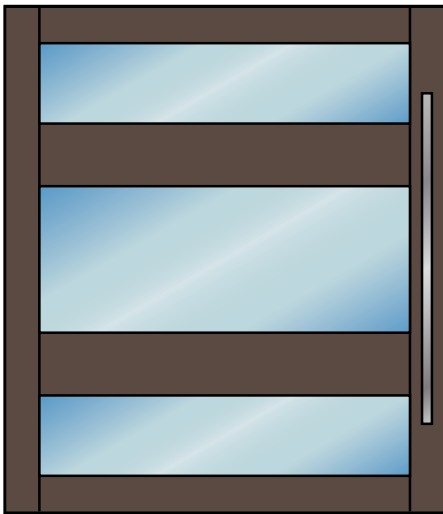

4

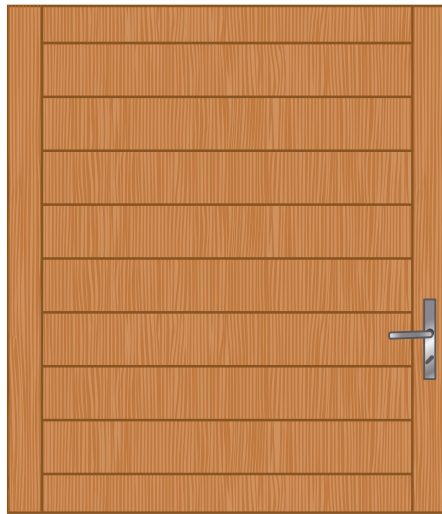

*5

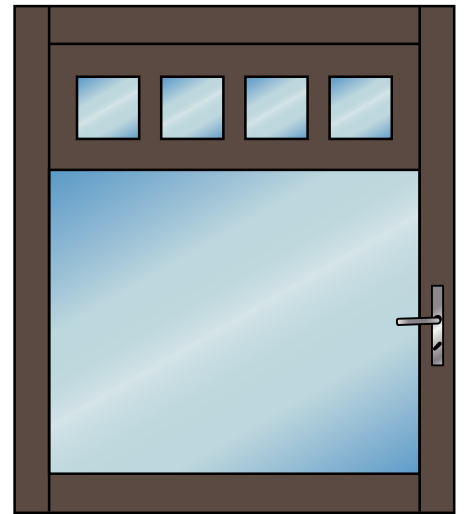

6

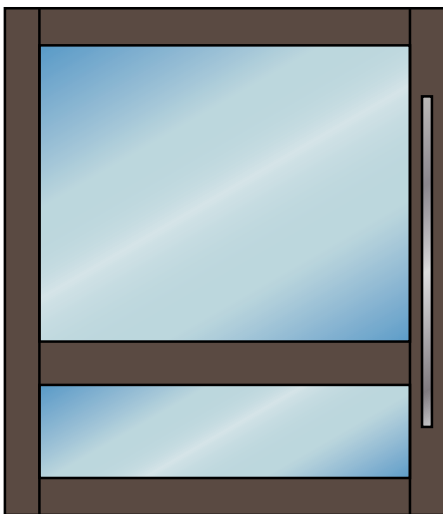

7



8

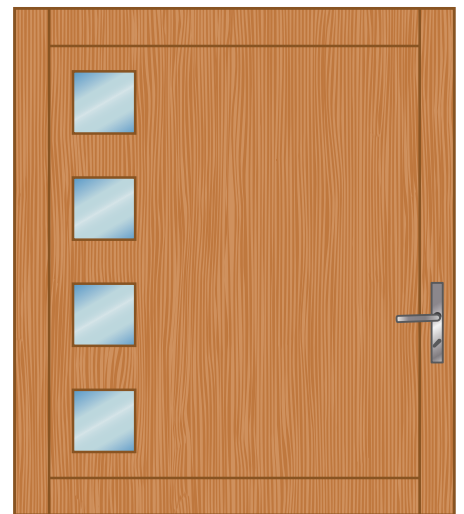

*9

**Configurations 2, 5 and 9 are available in wood or wood clad ONLY. All other pivot door samples are available in aluminum or aluminum with wood clad finish.*

PANEL & GLAZING CROSS SECTIONS

ALUMINUM & WOOD PANEL CROSS SECTION

Outswing Extrusion Shown

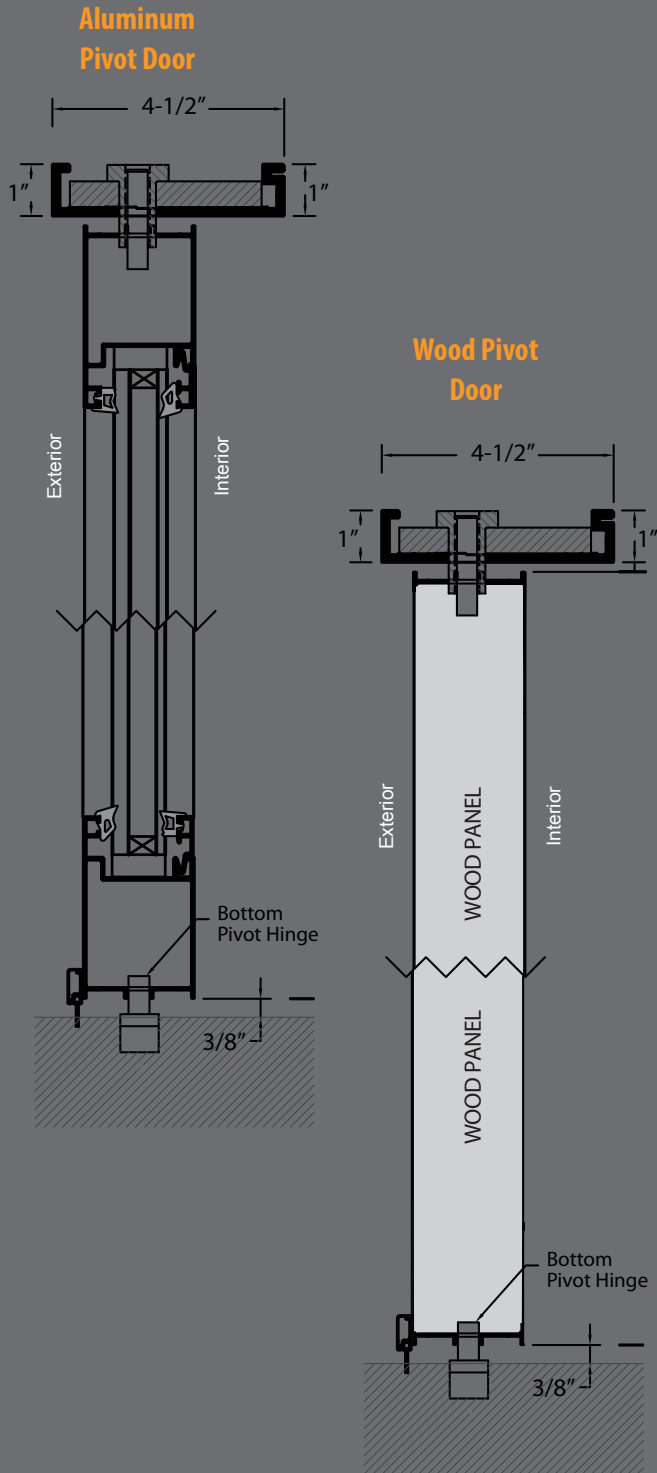

GLAZING DETAILS

Available glass options for the Euro Vista Pivot™ depends on the system options chosen. The system type and available glass options are as follows:

Aluminum Impact Rated Pivot Door

- Impact IG
- Impact 9/16" Monolithic

Aluminum Thermally Broken Pivot Door

- IG

Wood Pivot Door

- 1/4" Tempered
- 1/2" Tempered
- IG
- Impact IG
- Impact 9/16" Monolithic

Impact Glass (9/16" Monolithic)

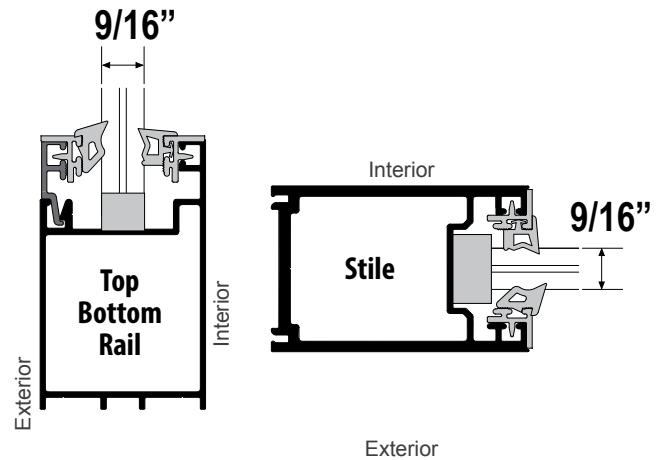

IG Impact

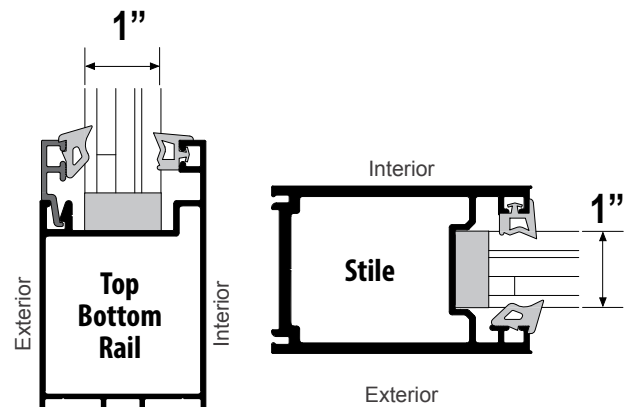

TEST PERFORMANCES

- Approved for use in Miami-Dade HVHZ Zones
- Florida Building Code Approved Product Approval FL 22410
- TAS 201 TAS 202 TAS 203
- AAMA / WDMA / CSA 101 / I.S.2 / A440-08 • NAFS-08
- Air Infiltration: A2
- Water Leakage Resistance: 60 DP
- Wind Load Resistance: 60 DP
- Wind Zone 4 (Hurricane) ASTM (cycling) E1996: DP60
- Wind Zone 4 (Hurricane) ASTM (impact) E1886: Pass
- Tested for Thermal Requirements

DESIGN PRESSURE CHART

Panel Width (Inches)

	40	44	48	50	56	60	66	69.5	72	
72	60.0	60.0	60.0	60.0	60.0	60.0	60.0	60.0	60.0	
78	60.0	60.0	60.0	60.0	60.0	60.0	60.0	60.0	60.0	
84	60.0	60.0	60.0	60.0	60.0	60.0	60.0	60.0	60.0	
90	60.0	60.0	60.0	60.0	60.0	60.0	60.0	60.0	60.0	
96	60.0	60.0	60.0	60.0	60.0	60.0	60.0	60.0	60.0	
102	60.0	60.0	60.0	60.0	60.0	60.0	60.0	60.0	60.0	
108	60.0	60.0	60.0	60.0	60.0	60.0	60.0	60.0	60.0	
114	60.0	60.0	60.0	60.0	60.0	60.0	60.0	60.0	60.0	
118.375	60.0	60.0	60.0	60.0	60.0	60.0	60.0	60.0	58.5	
120	60.0	60.0	60.0	60.0	60.0	60.0	58.8			
126	60.0	60.0	60.0	60.0	54.6	51.6				
132	60.0	60.0	51.5	49.7	45.0	42.5				
138	60.0	50.8	43.0	41.4	37.5					
144	60.0	42.7	36.1	34.8	31.4					

Product Approval FL 22410



EURO-WALL 10 YEAR WARRANTY

Euro-Wall warrants the products to be free from manufacturing defects for a period of 10 years from the date of purchase.

888.989.EURO (3876)

www.euro-wall.com

euro-wall[®]

FOLDING | SLIDING | STACKING

MANUFACTURING

2200 Murphy Court
North Port, Florida 34289
888.989.3876 • 941.979.5316

SHOWROOM

1211 Stirling Road, Unit 102,
Dania Beach, Florida 33004
954.610.2572

Proud Member of the American Architectural Manufacturers Association.

